

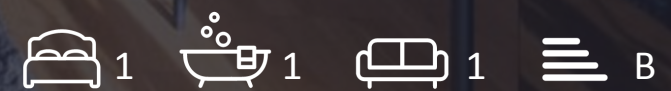

Arc House, London Bridge, SE1 3GP

Asking Price £450,000

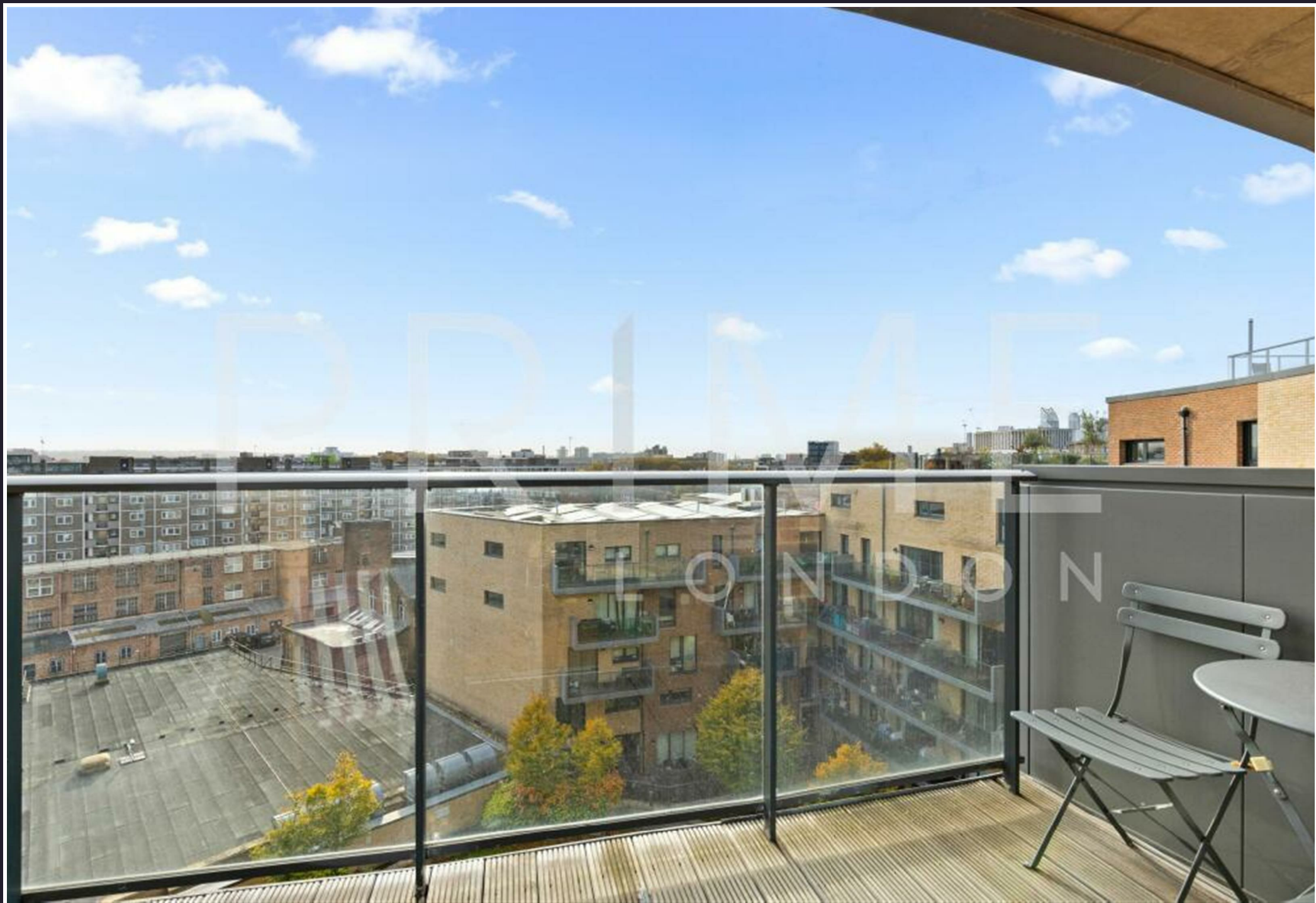





Asking Price £450,000

# Arc House

London Bridge, SE1 3GP

- One bedroom apartment
- Private balcony
- Access to day time concierge
- 553 sq ft (51.37 sqm)
- Central Location
- Close transport links

This bright one bedroom apartment in the Arc House Development spans 553 sq ft (51.37 sq m), and is available for sale through Prime London.

The apartment offers contemporary living in a modern development just moments from London Bridge. The open-plan living space is bathed in natural light from floor-to-ceiling windows and leads out to a private balcony. The sleek kitchen features high-quality integrated appliances and modern cabinetry, while the generous double bedroom includes mirrored built-in wardrobes for ample storage. A chic bathroom completes the home, boasting elegant tiling, premium fixtures, and a full-sized bath with overhead shower.

Residents of The Arc also benefit from a daytime concierge and secure private communal gardens.

Centrally located in the heart of London Bridge, Arc House development is only a short walking distance to Tower Bridges, bars, restaurants and gastro pubs.

Residents have excellent transport links via the River Taxi, and wonderful bus and overground train network, and both London Bridge and Tower Hill Underground Stations offering a platter of transport opportunities, including the Jubilee line (Bermondsey station) just a short 12 mins walk away.









Floor Plans

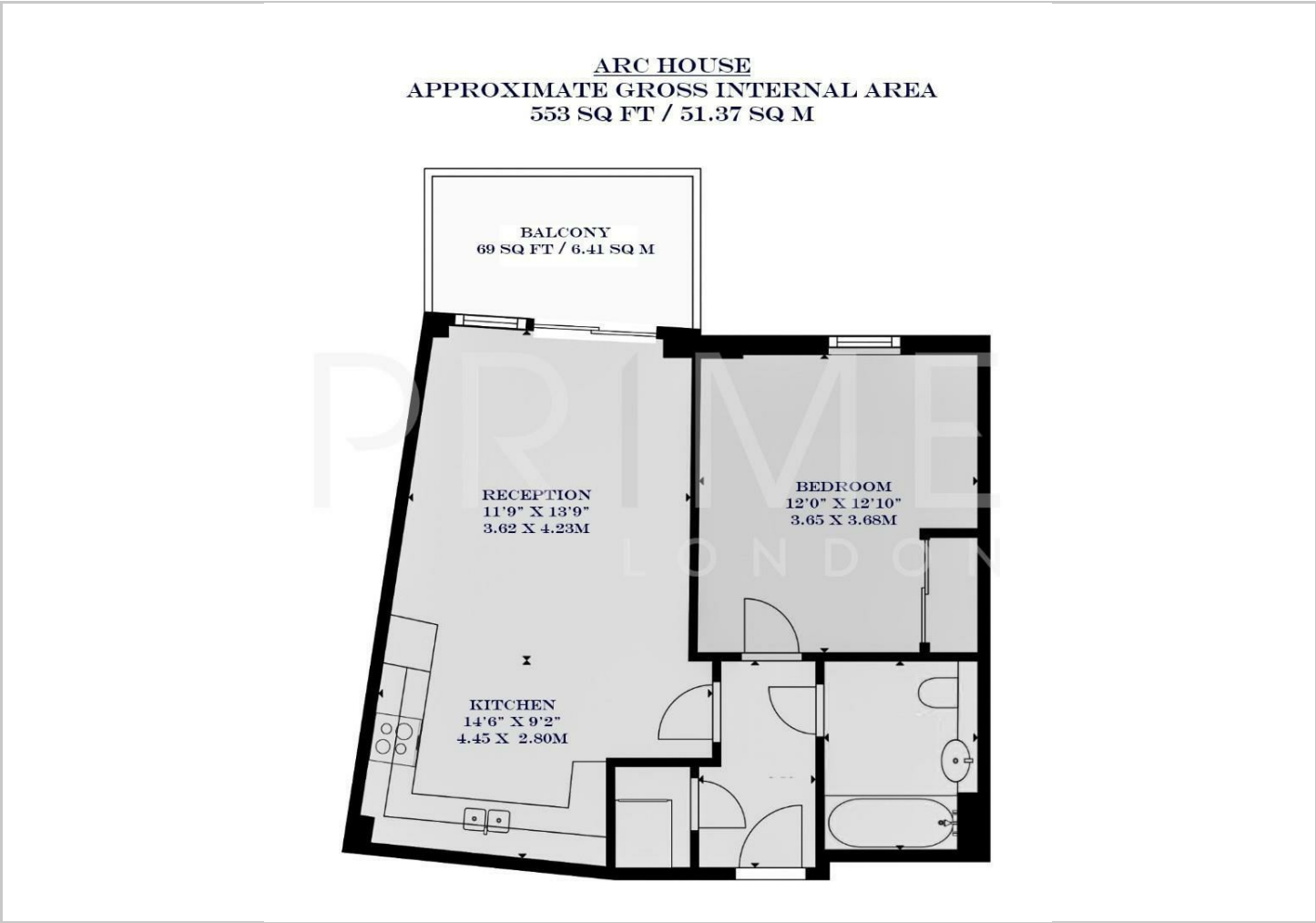

Viewing

By appointment. Contact us if you wish to arrange a viewing appointment for this property, or require further information.

The particulars are set out as a general outline only for the guidance of intended purchasers or lessees, and do not constitute, any part of a contract. Nothing in these particulars shall be deemed to be a statement that the property is in good structural condition or otherwise nor that any of the services, appliances, equipment or facilities are in good working order. Purchasers should satisfy themselves of this prior to purchasing.

Location Map

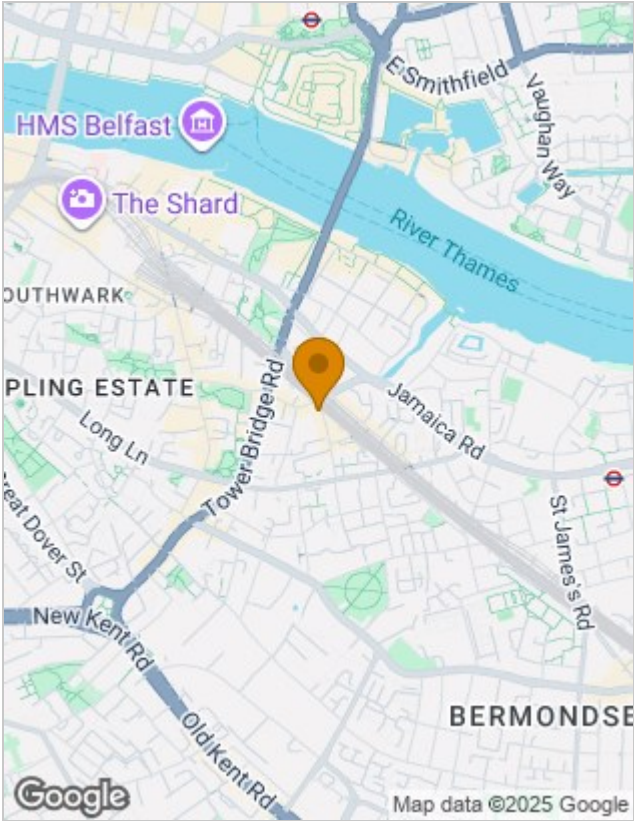

Energy Performance Graph

